

EVENT TENTS

Rental Close Out

SAVE 40%

all genuine WeatherPorts
includes side curtains & crates



Event Canopies

	Retail	YOUR PRICE
10x10	\$2,816	\$1,689
10x15	\$3,441	\$2,065
10x20	\$3,930	\$2,358
12x12	\$3,194	\$1,916
20x20	\$5,079	\$3,047

	Hexapae	
30' wide	\$6,507	\$3,904

	Octopae	
35' wide	\$9,645	\$5,787

	Jubilee	
15x20	\$4,493	\$2,696
18x31	\$6,945	\$4,167
20x30	\$6,459	\$3,875
30x30	\$11,103	\$6,662
30x40	\$13,403	\$8,042



Green House

8x10	GreenGable	\$789
17x20	GardenPort	\$3,735
17x30	GardenPort	\$4,769

EVENT TENT

10x10	Canopy	\$1,689	\$985
20X20	Canopy	\$3,047	\$2,540
30' dia.	Wedding Tent	\$3,904	\$3,254
18x31	Party Tent	\$4,167	\$3,473

Garage - Storage

12x25	CarPort	\$2,149	
13x30	CarPort	\$3,495	\$2,980
10x20	Storage	\$2,750	
26x20	Utility	\$3,400	
26x30	Shed	\$4,573	
18x40	RV Shelter	\$6,657	
30x60	Hay Shed	\$5,140	\$4,883

Engineered Shelters*

14x40	RV Garage	\$7,449	
24x48	Garage	\$13,829	
32x42	Shop	\$16,573	\$13,890
40x60	Barn	\$18,940	
50x60	Equipment Barn	\$25,034	
42x84	Equipment Barn	\$32,579	\$25,980
62X144	Riding Facility	\$57,352	

*add \$1800 for stamped drawings

HDPE Tension Fabric
10 TO 15 YEAR High Quality Fabric
INSTALL MANUAL

OVER 1000 Models

970-245-1000

www.cover1000.com

747 - B 23.5 Road
Grand Junction, CO 81505

SPECIALS
one in
stock **SAVE**

\$3,362 **10%**

\$985

\$2,540 **17%**

\$3,254 **17%**

\$3,473 **17%**

\$2,980 **15%**

\$4,883 **5%**

\$13,890 **16%**

\$25,980 **20%**

SPECIAL LOW PRICE - IN STOCK - INCLUDES BOTH ENDS*

32 x 42 \$16,573 NOW ONLY \$13,890

ATLAS 18 - 32' W

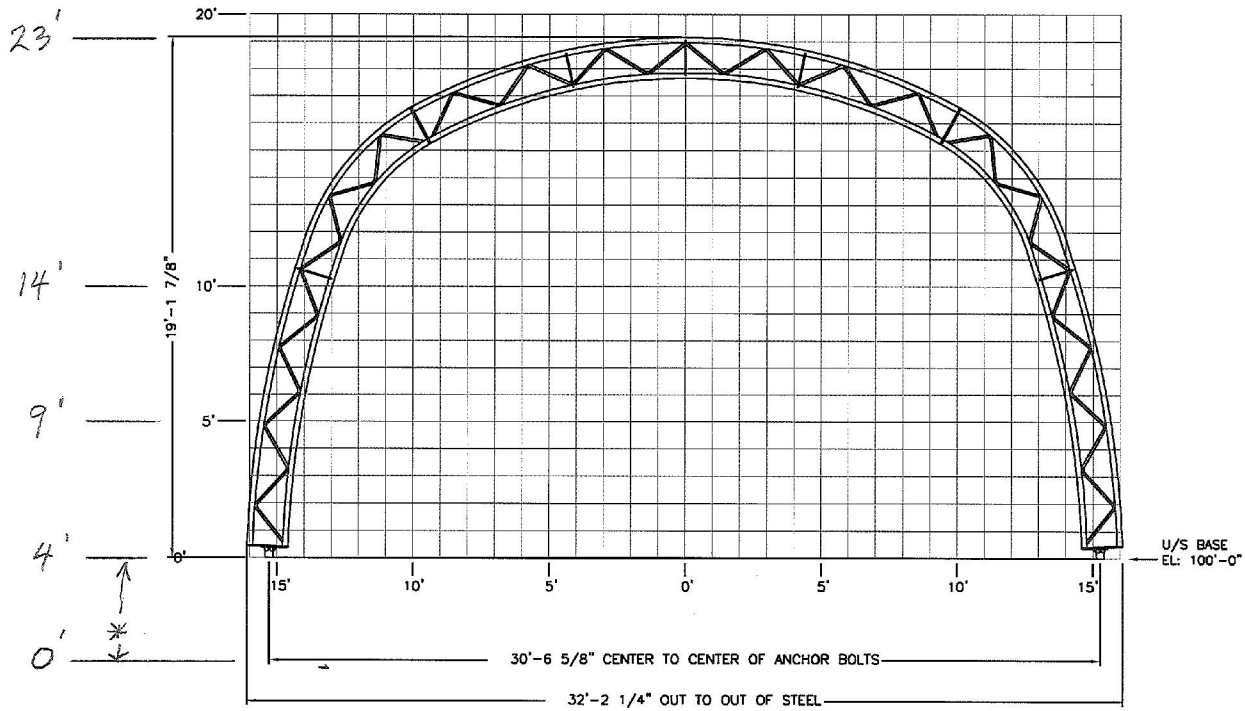

* ENDS ADJUSTABLE 0' TO 4' EXTENSION

□ = 1' x 1' GRID

		37651 Amberley Road Lucknow, ON, Canada N0G 2H0 PH: 1-519-528-2922 FAX: 1-519-528-2890		DEALER	CUSTOMER:	PROJECT:			
		THIS DRAWING IS PROPERTY OF BRITESPAN ANY REPRODUCTION IN WHOLE OR IN PART WITHOUT THE EXPRESSED WRITTEN CONSENT OF BRITESPAN IS PROHIBITED. THIS DRAWING IS NOT TO SCALE UNLESS OTHERWISE NOTED.	WIDTH-STEEL-FAB-HSS-HSSDROP 32	TAB TITLE: 005	DRAWING TITLE: ATLAS 32 - 320 GM PROFILE			PROJECT ID:	SO/ORDER ID:
DETAILER: LS	DWG REV: 1	REVISED BY: DESCRIPTION 1	DATE 11 JAN 11						
CHECKER: LL									

SPECIAL LOW PRICE - IN STOCK - INCLUDES BOTH ENDS

42 x 84 \$32,579 NOW ONLY \$25,980

□ 1'x1' GRID

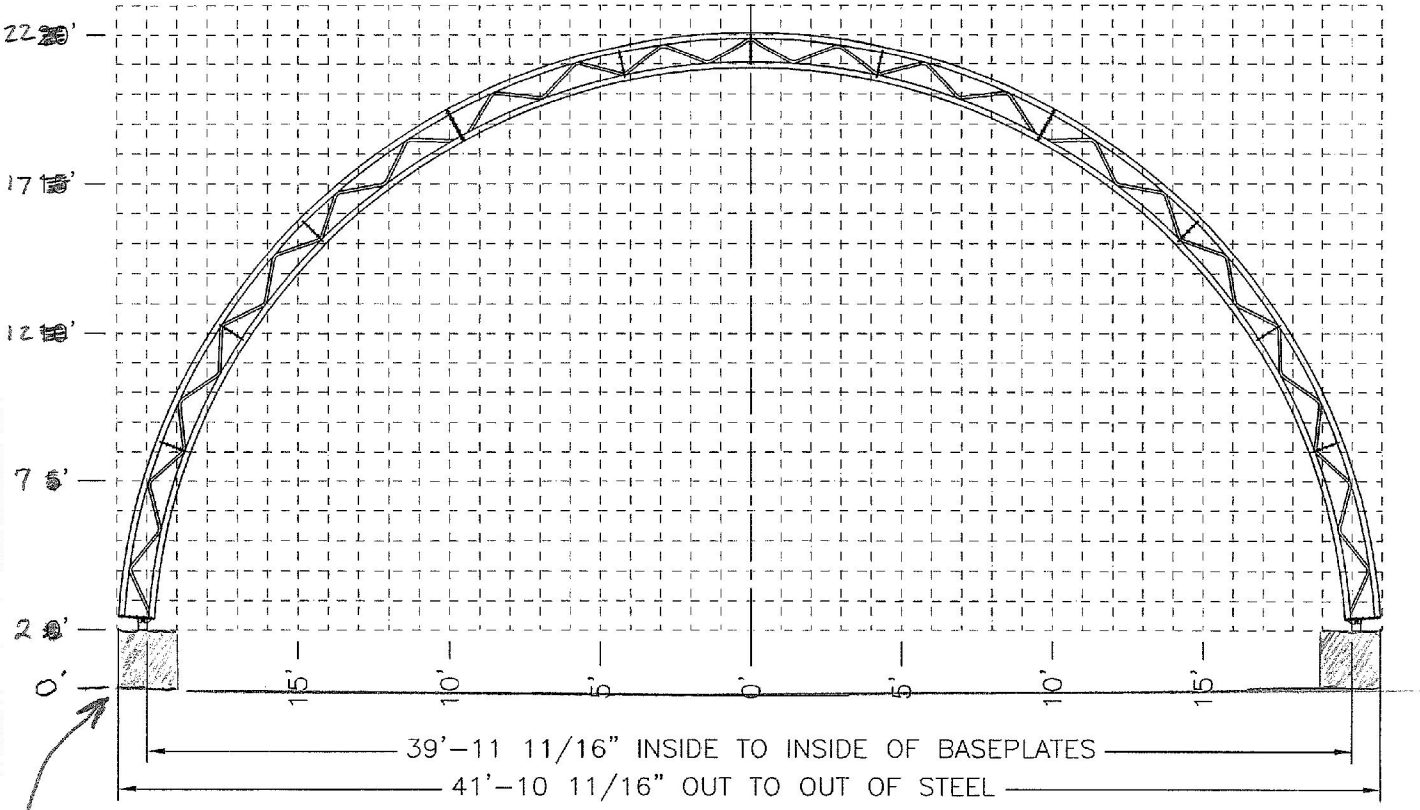

42' LBS
 PRECAST BLOCK, GRADE BEAM OR POST (NOT INCLUDED)

REV.	DESCRIPTION	BY	DATE
1	RELEASED	AB	25 NOV 03

DEALER:	
CUSTOMER:	
PROJECT:	
PROJECT ID:	
ORDER ID:	

THIS DRAWING IS PROPERTY OF COVER-ALL BUILDING SYSTEMS INC. ANY REPRODUCTION IN WHOLE OR IN PART WITHOUT THE EXPRESSED WRITTEN CONSENT OF COVER-ALL BUILDING SYSTEMS INC. IS PROHIBITED.

DRAWN BY: AB DATE: 25 NOV 03
 CHECKED BY: [Signature] DATE: 12 DEC 03
 SCALE: NTS

3615 WANUSKOWIN RD. SASKATOON, SASKATCHEWAN, S7P 1A1
 PH: 1-306-657-2688 FAX: 1-306-657-2762
 WEBSITE: www.coverall.net E-MAIL: tech@coverall.net

COVER-ALL
 BUILDING SYSTEMS

TITLE: LBS12 42 GRID PROFILE SHEET: 1 REVISION: 1